

# FMF1227 FM-101

主な用途 / プリンター  
歯ブラシ

Main Application / Printing machine  
Toothbrush

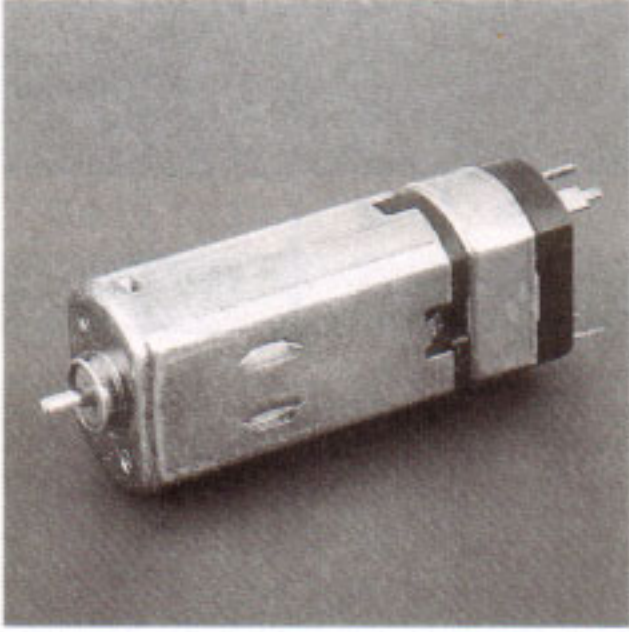

MODEL	VOLTAGE		NO LOAD		AT MAXIMUM EFFICIENCY				STALL		
	OPERATING RANG	RATED	SPEED	CURRENT	TORQUE		SPEED	CURRENT	TORQUE		CURRENT
			r/min	A	g-cm	mN-m	r/min	A	g-cm	mN-m	A
FMF1227 D	1~3	3.5	8100	0.07	6	0.59	7500	0.26	30	2.96	0.98
FMF1227 C	2~8	5	9500	0.05	6.5	0.64	5900	0.14	24	2.38	0.37

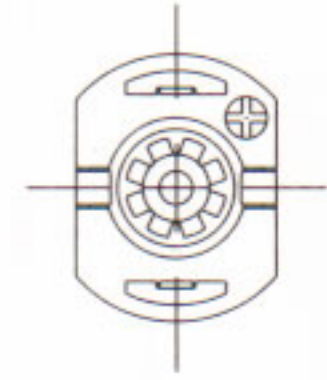
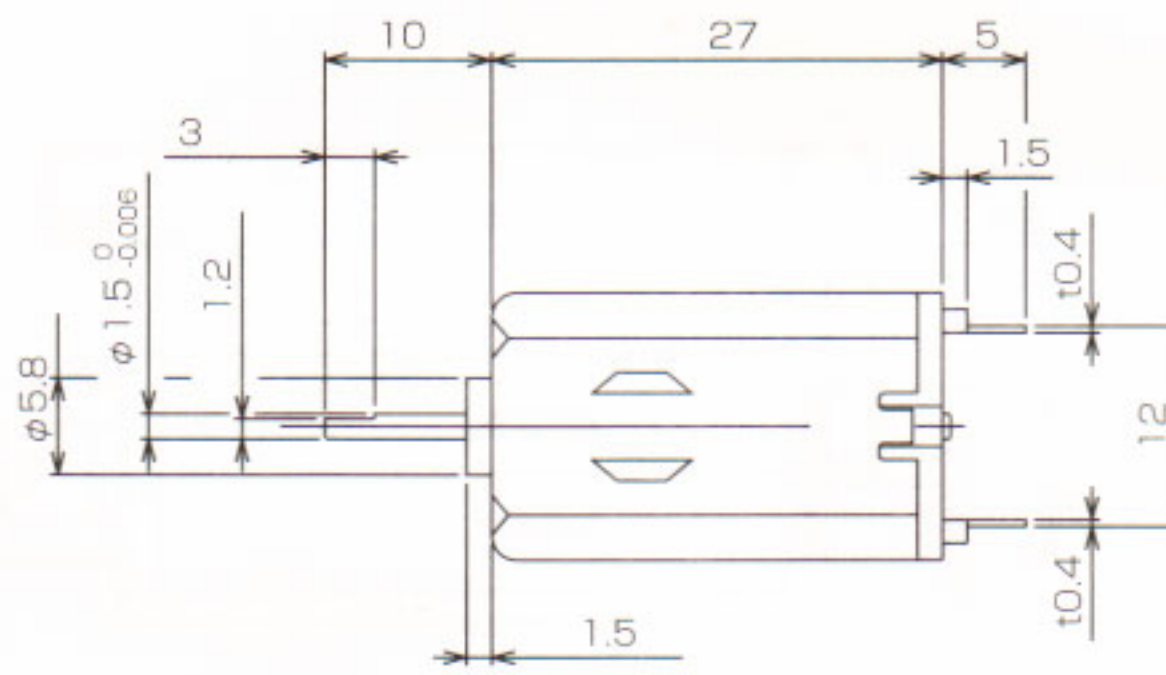
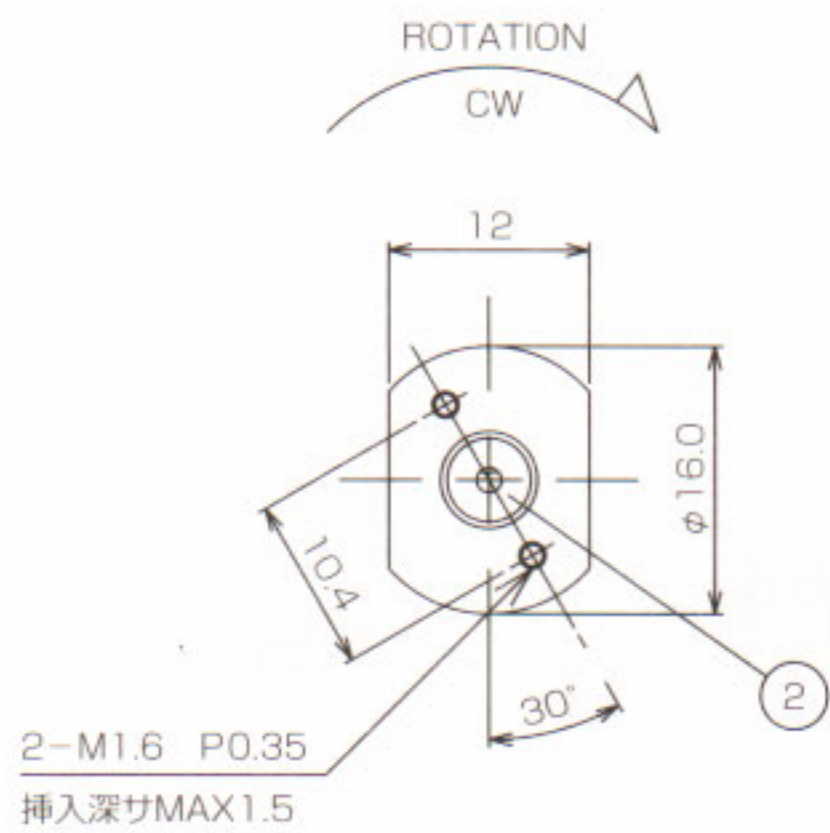

WEIGHT : 28g

## FMF1227 C

5V

## FMF1227 D

3.5V

